

# 建设用地规划红线图

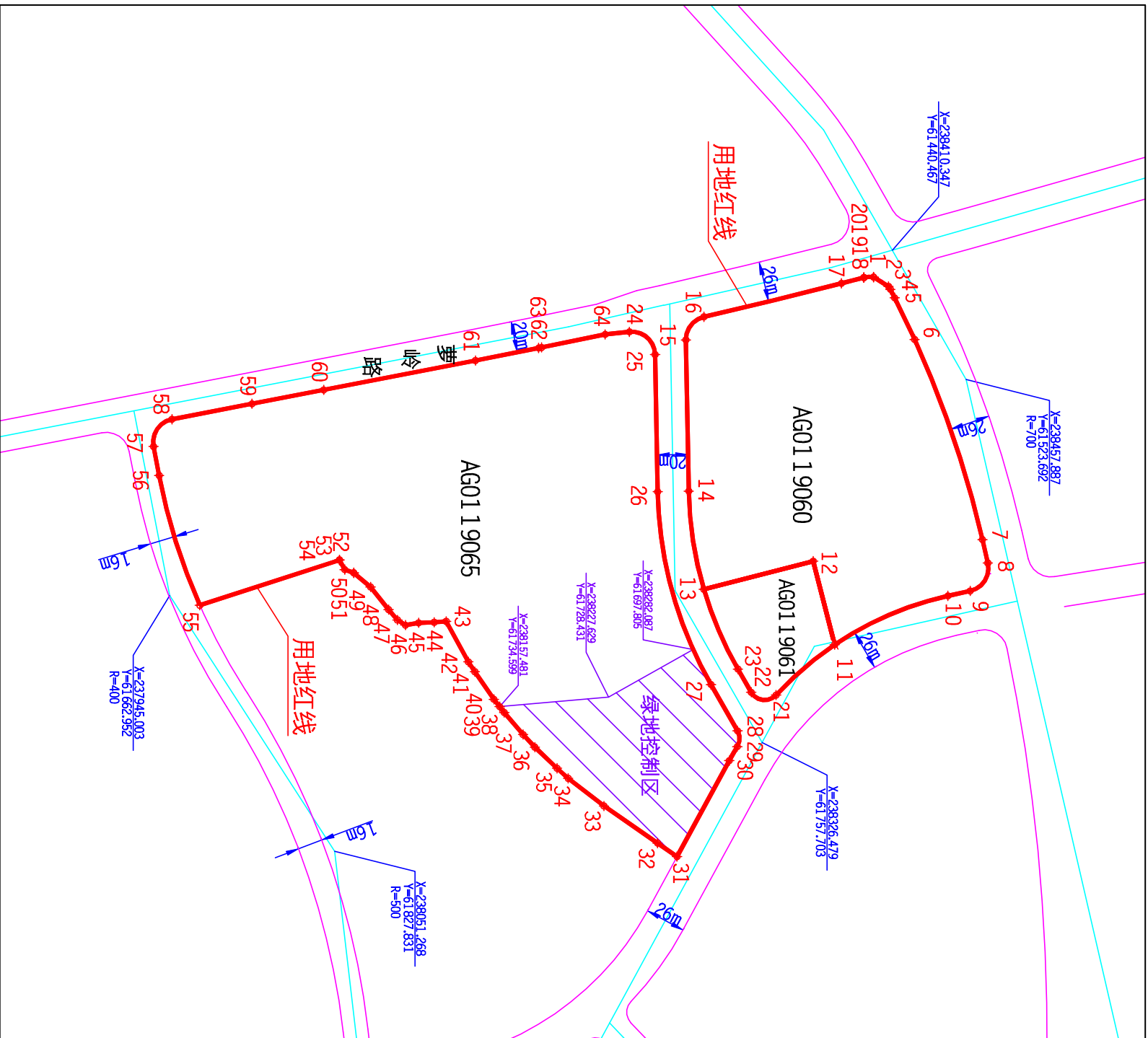

地上桩点表 (共 64 个桩点)															
广州2000坐标系				2000国家坐标系				广州2000坐标系				2000国家坐标系			
序号	桩点(米)	桩点(米)	序号	桩点(米)	桩点(米)	序号	桩点(米)	桩点(米)	序号	桩点(米)	桩点(米)				
1	238398.268	61457.800	1	2568094.376	448116.444	56	237938.189	61566.632	56	2567633.668	448242.045				
2	238398.301	61457.820	2	2568094.409	448116.465	57	237934.575	61566.959	57	2567630.446	448232.355				
3	239407.921	61465.867	3	2568104.000	448122.498	58	237946.409	61549.394	58	2567642.065	448205.847				
4	239409.111	61465.696	4	2568105.181	448120.993	59	237997.987	61539.413	59	2567693.692	448196.116				
5	239411.865	61471.145	5	2568107.910	448129.855	61	238141.877	61511.559	61	2567739.892	448187.403				
6	239424.710	61497.961	6	2568120.624	448156.734	62	238182.608	61503.458	62	2567878.491	448168.957				
7	239436.382	61492.937	7	2568163.670	448286.925	63	238182.608	61503.458	63	2567878.491	448168.957				
8	239471.865	61642.023	8	2568167.081	448301.028	64	238225.417	61494.710	64	2567921.343	448182.516				
9	239460.507	61660.040	9	2568155.635	448318.989	地上桩点表 (共 17 个桩点)									
10	239464.187	61663.226	10	2568141.299	448322.107										
11	239393.223	61669.637	11	2568086.192	448353.164										
12	238389.393	61640.848	12	2568064.612	448299.307										
13	238288.965	61668.951	13	2567994.115	448311.069										
14	238279.280	61695.708	14	2567974.697	448323.777										
15	238277.420	61498.289	15	2567973.330	448156.348										
16	238289.029	61483.394	16	2567965.011	448141.509										
17	238377.594	61461.794	17	2568073.682	448120.337										
18	238392.010	61458.075	18	2568088.117	448116.689										
19	238392.016	61458.074	19	2568088.123	448116.688										
20	238392.117	61458.040	20	2568088.224	448116.662										
21	238335.517	61727.124	21	2568031.317	448386.469										
22	238319.471	61725.331	22	2568014.279	448383.597										
23	238310.927	61710.404	23	2568005.808	448366.629										
24	238241.045	61493.084	24	2567936.960	448150.966										
25	238267.595	61507.721	25	2567953.458	448165.683										
26	238259.263	61596.096	26	2567954.698	448346.058										
27	238293.569	61720.340	27	2567988.401	448378.480										
28	238310.660	61750.198	28	2568005.347	448406.422										
29	238310.523	61760.366	29	2568005.161	448418.590										
30	238305.327	61761.388	30	2567999.921	448427.587										
31	238271.692	61831.242	31	2567965.966	448489.279										
32	238259.176	61822.559	32	2567953.511	448480.535										
33	238274.650	61796.608	33	2567919.101	448456.416										
34	238201.602	61786.797	34	2567896.140	448348.492										
35	238194.433	61774.314	35	2567899.002	448313.975										
36	238180.133	61760.699	36	2567874.767	448418.590										
37	238172.554	61752.562	37	2567867.228	448410.116										
38	238160.445	61738.387	38	2567855.187	448396.882										
39	238157.483	61734.602	39	2567852.244	448392.083										
40	238153.771	61729.893	40	2567848.555	448391.355										
41	238141.487	61712.091	41	2567836.357	448389.433										
42	238137.337	61705.733	42	2567832.238	448363.115										
43	238123.058	61679.664	43	2567818.095	448336.976										
44	238115.274	61680.235	44	2567810.298	448331.510										
45	238105.268	61680.569	45	2567800.290	448337.795										
46	238095.803	61682.068	46	2567791.817	448332.253										
47	238091.662	61678.741	47	2567786.693	448335.901										
48	238085.930	61672.069	48	2567780.993	448329.201										
49	238074.330	61667.473	49	2567769.463	448314.549										
50	238063.488	61668.363	50	2567758.665	448306.366										
51	238053.478	61648.353	51	2567758.665	448306.376										
52	238057.690	61646.267	52	2567752.878	448303.262										
53	238054.334	61640.038	53	2567749.552	448297.016										
54	238054.256	61640.150	54	2567749.474	448297.128										
55	237964.353	61689.274	55	2567659.428	448235.816										

附注: 本图采用广州2000平面坐标系和高程系统; 图中界桩坐标表之2000国家坐标数据供国土等部门参考使用。